

A quick guide to setting up your integration

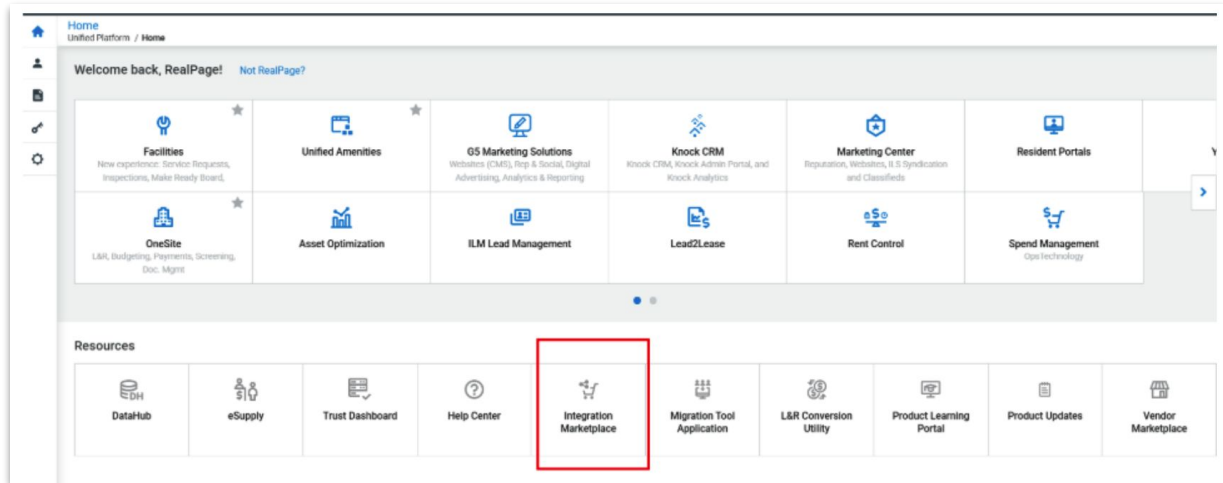

1. Log in to the Unified Platform.

2. Navigate to the Integration Marketplace.



3. Search for "PetScreening" and initiate the search.

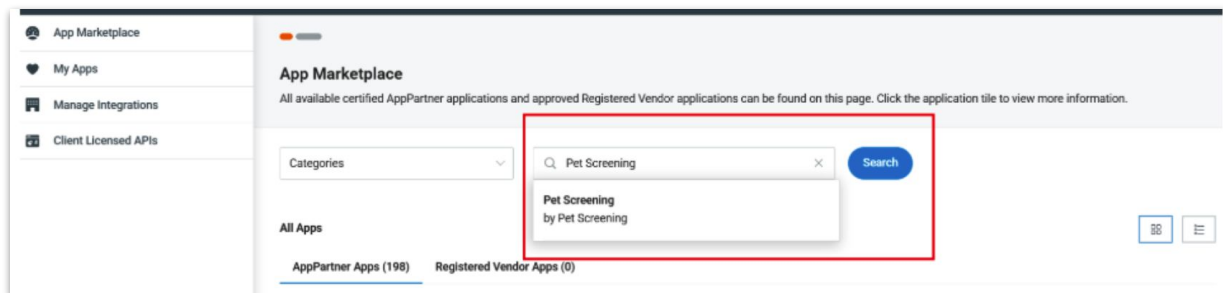

A quick guide to setting up your integration



4. Click on the PetScreening tile (a) and then click "Integrate Now" (b).

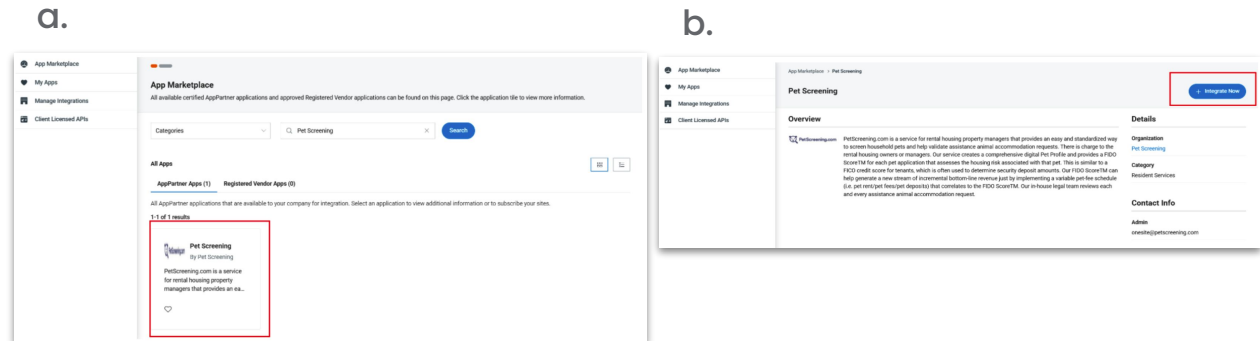

5. Locate the property name you wish to integrate and enable the toggle icon. Click "Save"; the status will then appear as pending.

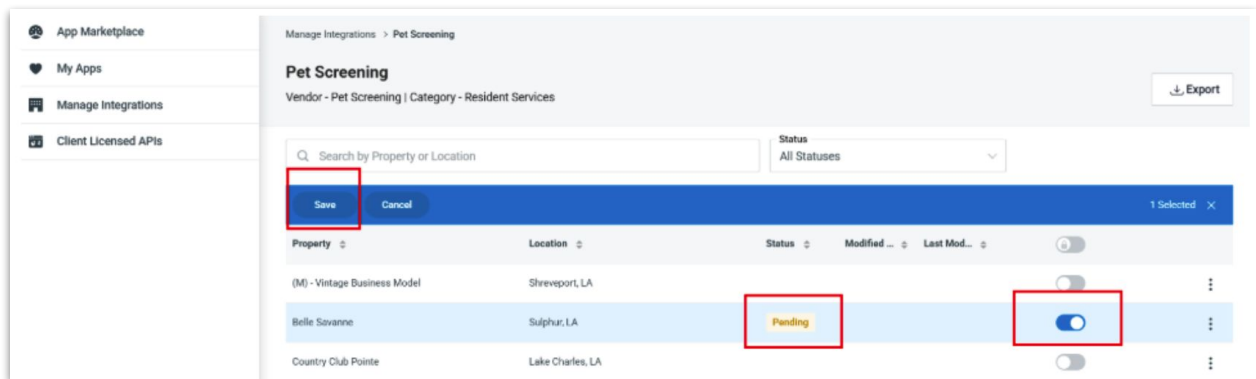

6. Notify us via email so that we can approve the integration request through our developer portal.

Please note: Clients can integrate with RealPage Classic settings or Unified Settings as long as the client has Marketplace.